

Anlage 2

Lageplan und Bohrprofile (Auszug aus Baugrunduntersuchungen)

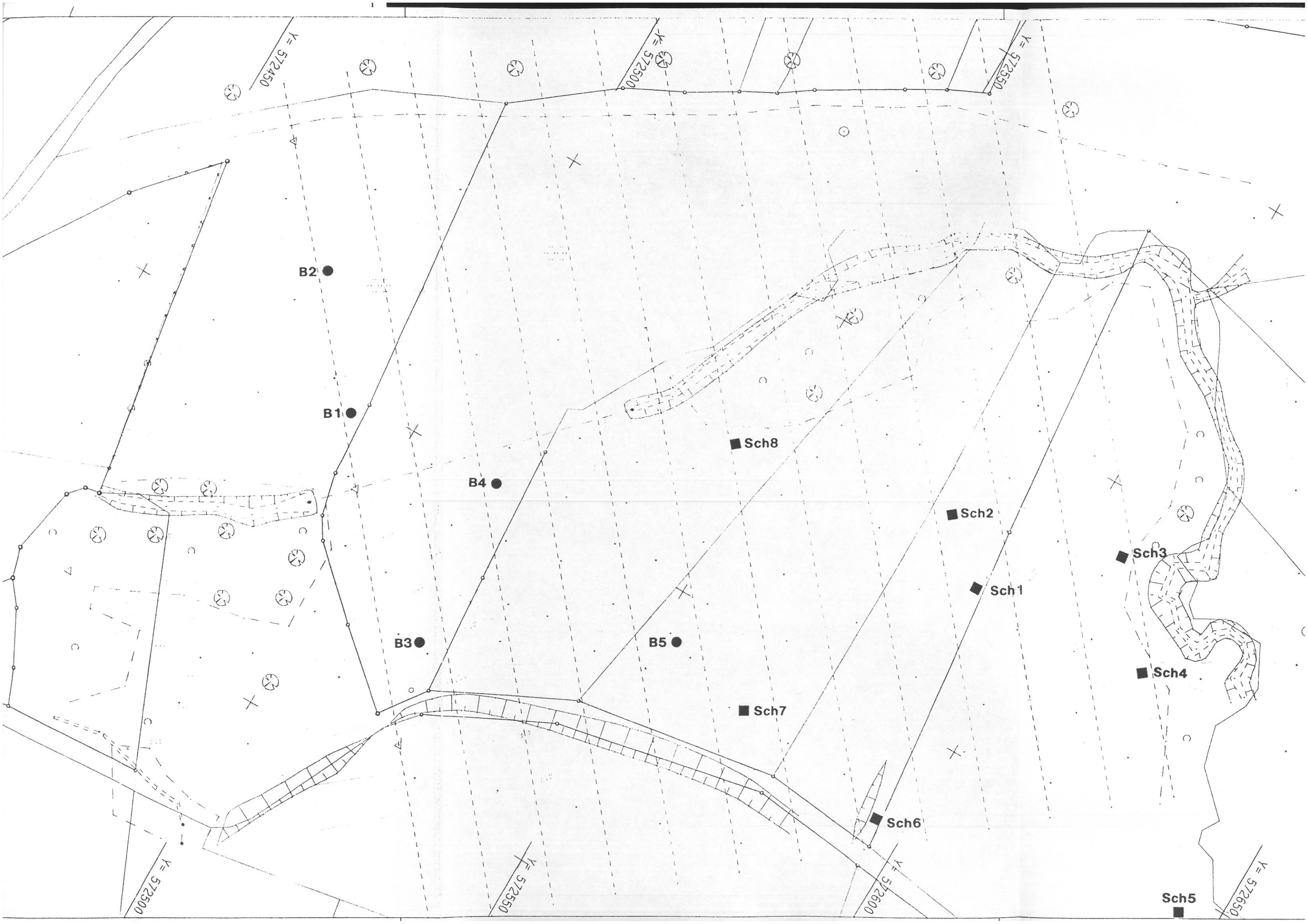

Y = 572450

Y = 572500

Y = 572550

B2 ●

B1 ●

B4 ●

B3 ●

B5 ●

■ Sch8

■ Sch2

■ Sch1

■ Sch3

■ Sch4

■ Sch7

■ Sch6

■ Sch5

Y = 572500

Y = 572550

Y = 572600

Y = 572650

B 1

Ansatzpunkt [m]: 408.21

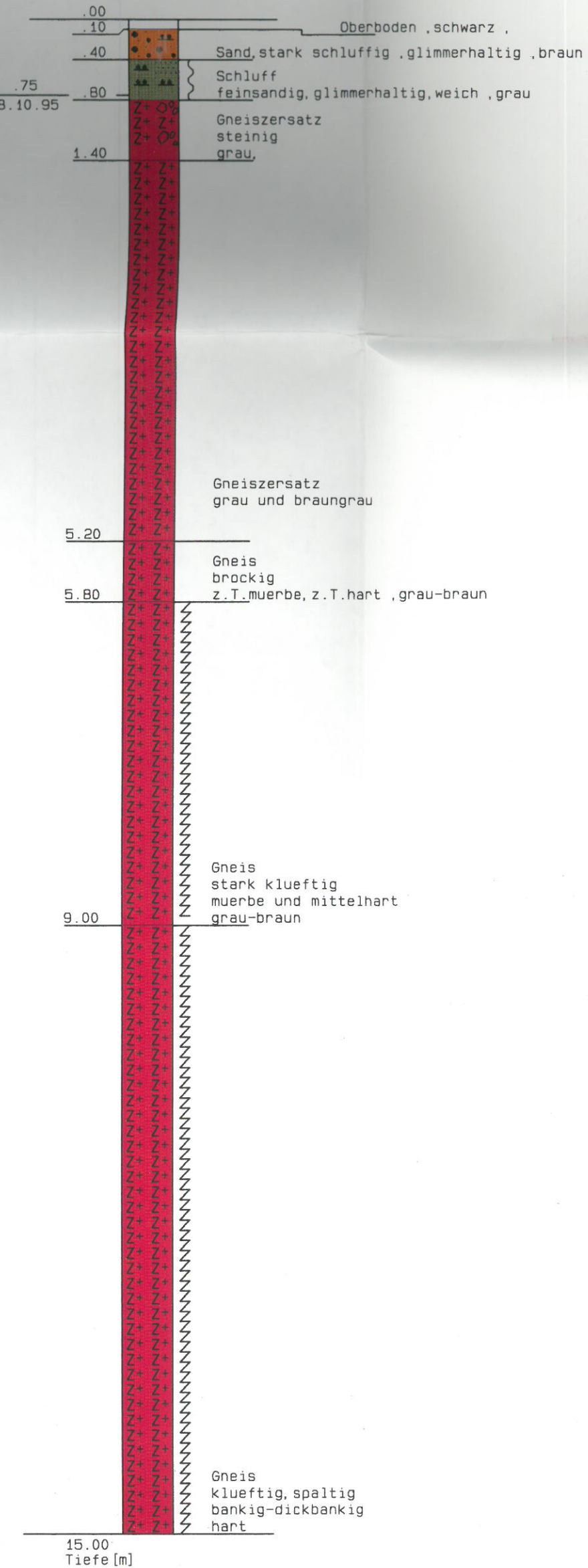

15.00
Tiefe [m]

B 2

410.00 m

Ansatzpunkt [m]: 409.38

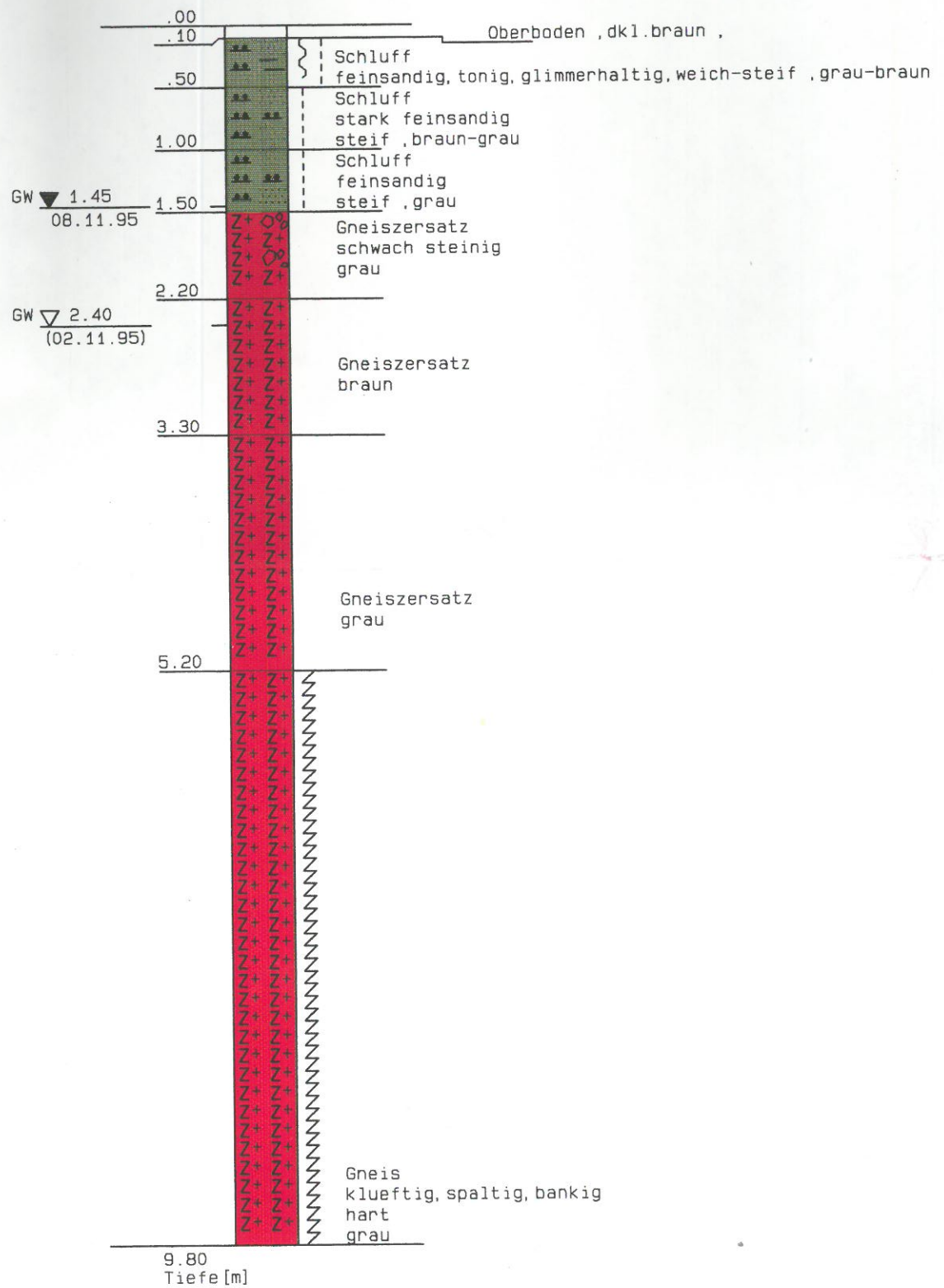

405.00 m

400.00 m

B 3

Ansatzpunkt [m]: 412.59

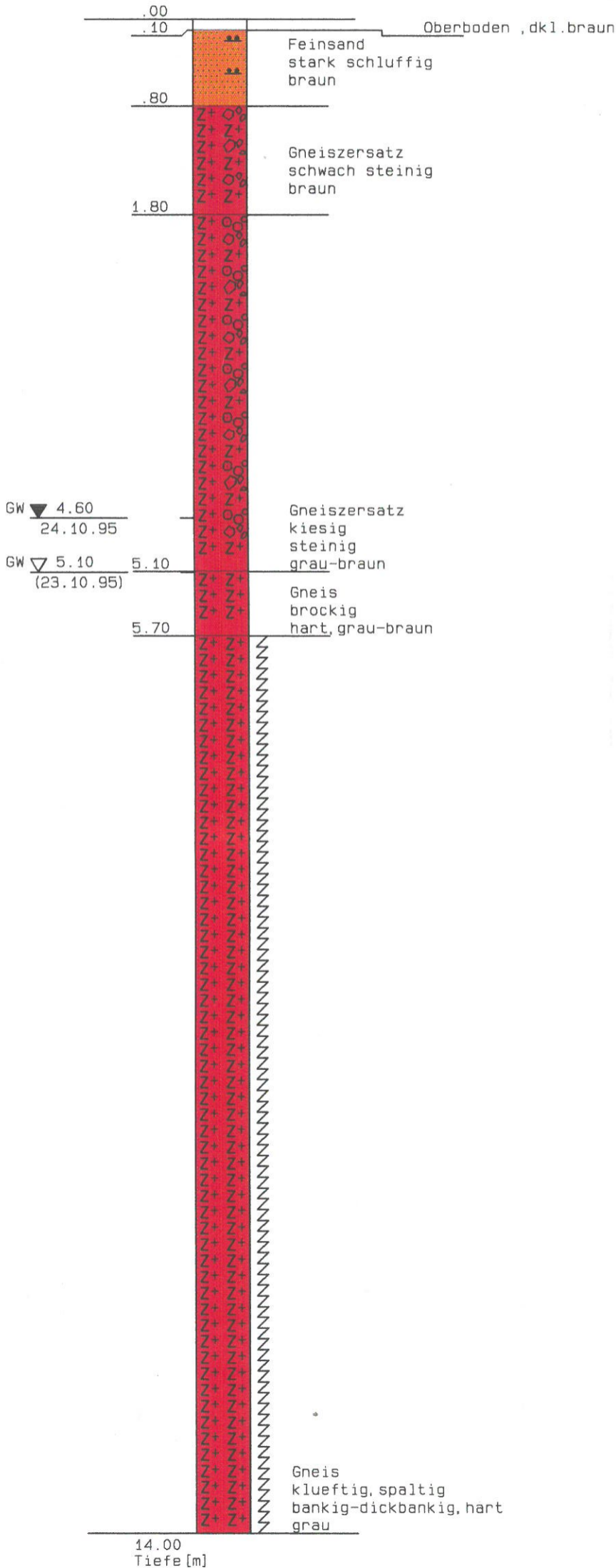

415.00 m

410.00 m

405.00 m

400.00 m

B 4

Ansatzpunkt [m]: 408.98

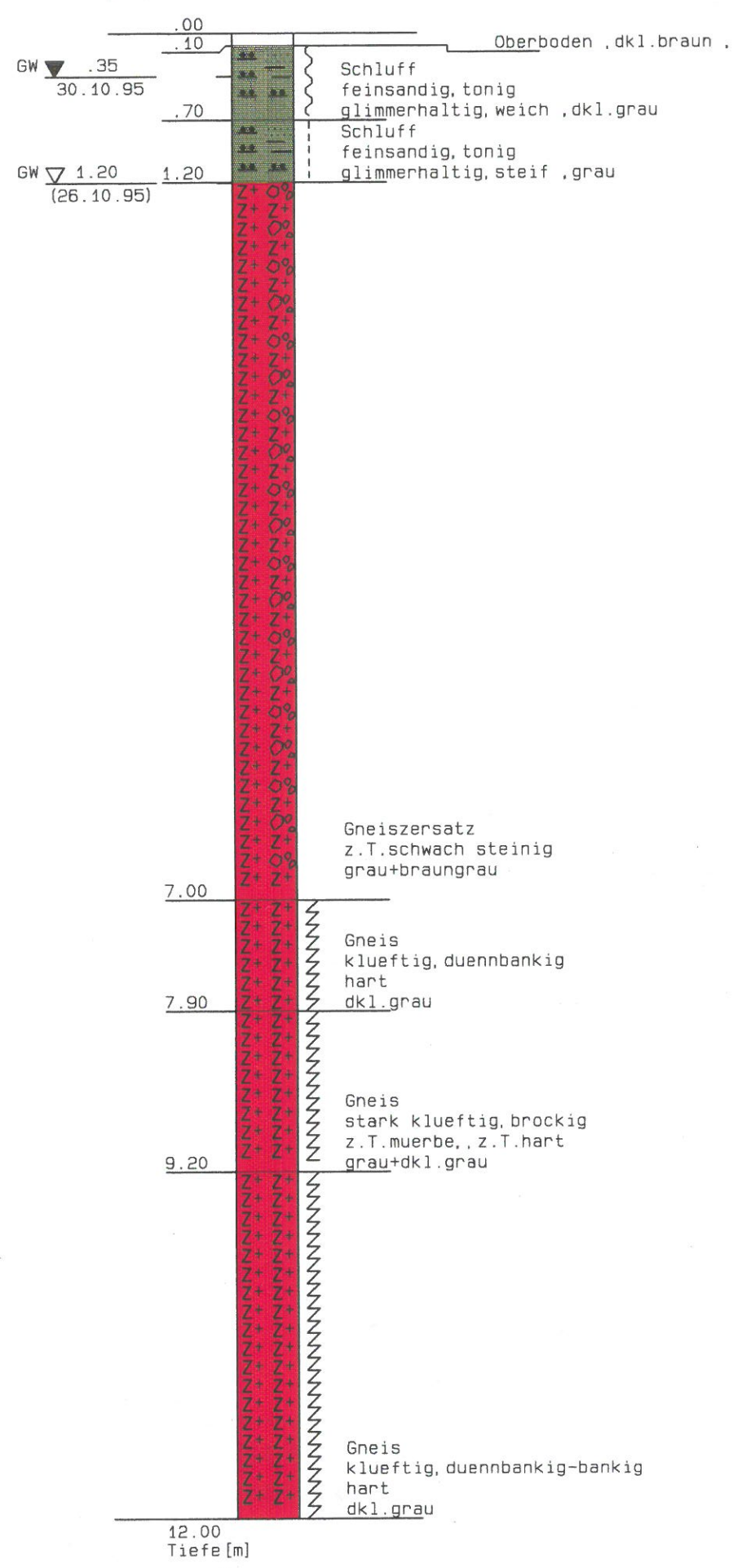

Ansatzpunkt [m]: 414.23

